

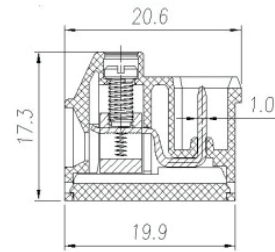

PCB Terminal Blocks Pitch Panel Mount Terminal Block Header ASIWJ2EDGGBM-5.08

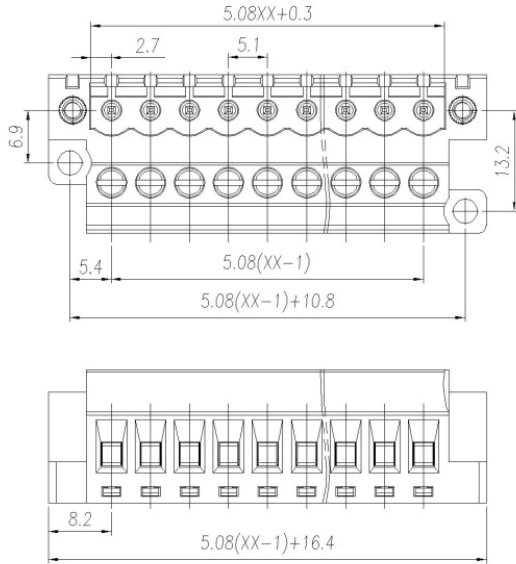

Certification	
	
Material	
Screw	M3.0 Steel, Tin Plated
Lock Nut	M2.5, Brass
Pin/Plate	Brass, Tin Plated
Cage	Brass, Nickel Plated
Housing	PA66, UL 94V-0, Green
Electrical	
Standard	UL 1059/CSA C22.2 No. 158
Rated Voltage	300 V
Rated Current	15 A
Wire Range	28-14 AWG
Contact Resistance	20mΩ
Insulation Resistance	500MΩ/500 Vdc
Withstand Voltage	2000 Vac/1 Min
Mechanical	
Temperature Range	-40°C...+105°C
Torque	0.5N-m (4.4lb-in)
Strip Length	7-8 mm (0.28-0.31")
Size	
Pitch	5.08 mm (.200")
Poles	2P-16P. Additional sizes available on request.

Item	No. of Poles	Length (mm)
ASIWJ2EDGGBM-5.08-2P	2	21.48
ASIWJ2EDGGBM-5.08-3P	3	26.56
ASIWJ2EDGGBM-5.08-4P	4	31.64
ASIWJ2EDGGBM-5.08-5P	5	36.72
ASIWJ2EDGGBM-5.08-6P	6	41.8
ASIWJ2EDGGBM-5.08-7P	7	46.88
ASIWJ2EDGGBM-5.08-8P	8	51.96
ASIWJ2EDGGBM-5.08-9P	9	57.04
ASIWJ2EDGGBM-5.08-10P	10	62.12
ASIWJ2EDGGBM-5.08-11P	11	67.2
ASIWJ2EDGGBM-5.08-12P	12	72.28
ASIWJ2EDGGBM-5.08-13P	13	77.36
ASIWJ2EDGGBM-5.08-14P	14	82.44
ASIWJ2EDGGBM-5.08-15P	15	87.52
ASIWJ2EDGGBM-5.08-16P	16	92.6